



 **LIFESHELTER**[®]

Designed and developed by Evershelter Innovation Team



“We are dedicated to improving living standards for refugees and internally displaced populations by providing sustainable and dignified low-cost shelter solutions”

Jakob Christensen, Evershelter’s CEO & founder



SUSTAINABLE
BUILD



WINNER
2016

Lifeshelter® - sustainable shelter solutions

Cost-effective high-quality shelter and housing solutions for multiple purposes worldwide. Together with our internationally renowned partners we work tirelessly to provide dignified shelter solutions that are produced locally for the worlds poorest and most vulnerable populations.

Products



Lifeshelter® Family

- Well-insulated
- Fire resilient
- Sturdy
- Safe

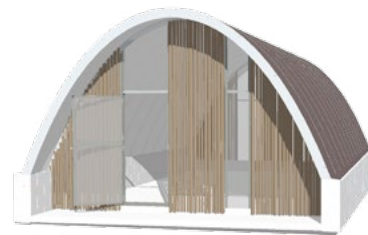

Lifeshelter® Classroom

- Cross-ventilated
- Sound insulated
- Quick setup
- Highly scaleable

Impact



Local Production

- Local jobs
- Economic growth
- Upgrading skills
- Export opportunities



Sustainable Impact

- Reusable
- Recyclable
- Durable
- Energy efficient

The largest ever humanitarian crisis

65.6 million people have been forced to leave the safety of their homes to face an uncertain future. The tents and shelters typically used in refugee camps provide inadequate living conditions.



A safe family home

Our award-winning design offers a safe and secure shelter resistant to all weather conditions.

The Lifeshelter® Family are constructed with unique insulating panels that ensure a more energy efficient and healthier indoor environment in all climates. The sturdy construction, sound insulation and lockable doors offer the families a feeling of safety and privacy in an often cramped and tense setting.



Lifeshelter® Family

Specifications*



Expected Life Span	10+ years
Assembly Time	3-4 hours / 2 people
Floor Area	~18 m2
Dimensions (HxWxL)	2.20x3.75x4.72m
Door dimension	H:196cm W: 80cm
Fire Safety	Euro Class: b2sd0
Wind Speed Resistance	120 km/t / 32,6 m/s
Thermal Conductivity	0,039W/m²*K
Total Weight	456 kg
Container (40 ft.)	38 shelters

*Subject to customer preferences



Earthquake resistant



Fire resistant



Hurricane resistant



Resistant to both high and low temperatures



Noise reducing



Waterproof



Produced locally

Construction

A 18m² shelter consists of 16 curved insulation panels placed on a steel floor frame. There are lockable doors with ventilation at each end of the shelter. The structure is tightened with steel rods.

Roofing felt or a tarpaulin is applied to the panels to make it weather-proof and increase the life span of the shelter.

The shelter is termite proof.

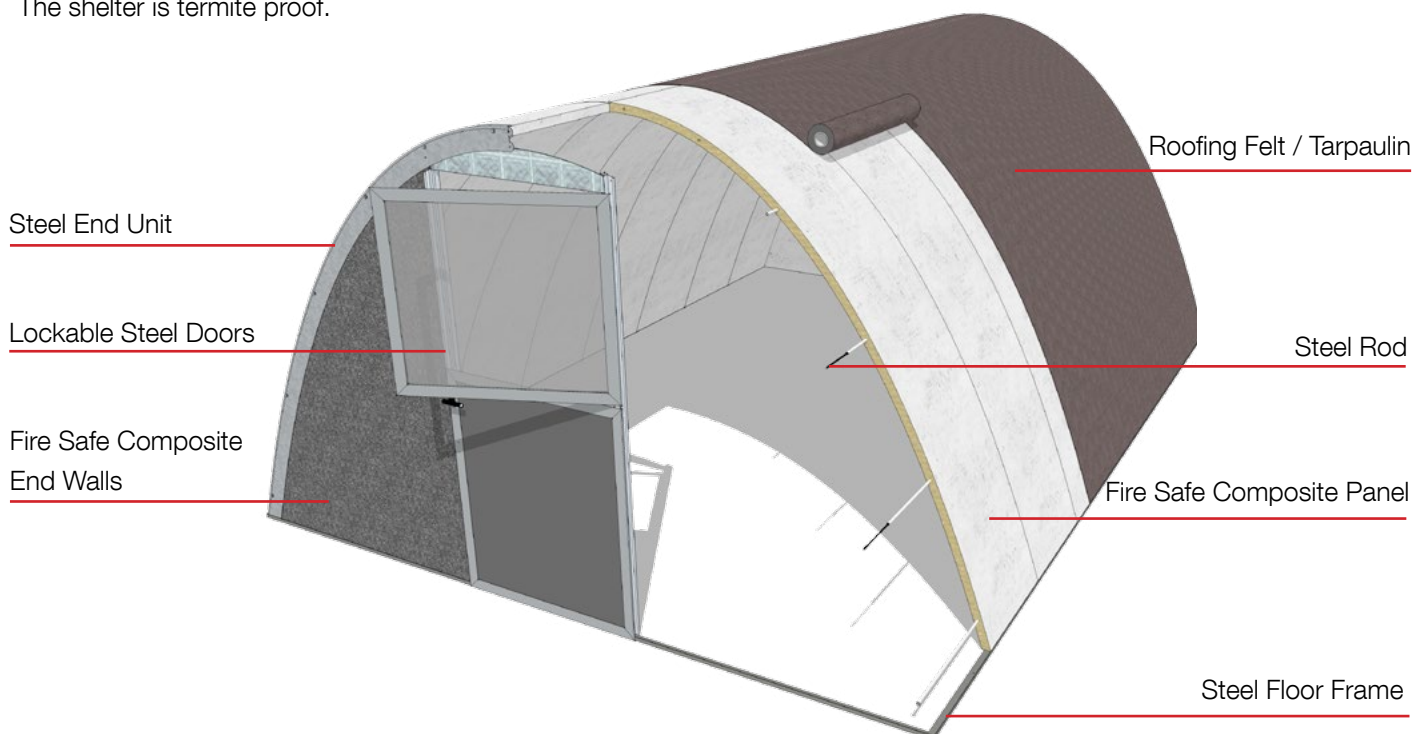

The education crisis

194 million children and adolescents worldwide do not attend primary school, due to lack of proper learning environments, educational material and sociocultural circumstances.

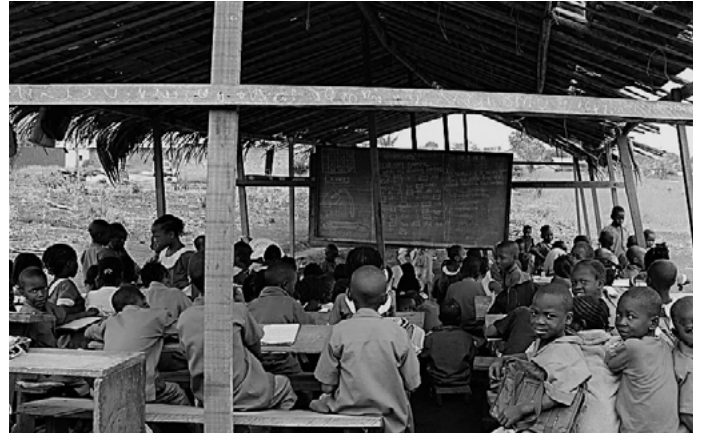

Lifeshelter® Classroom- a proper learning environment

Our Lifeshelter® Classrooms - a series of cost-effective high-quality classrooms - provide a proper learning environment developed to comply with local conditions.

The unique insulation panels prevent radiation heat and reduce noise from the outside significantly and the ventilated end-walls ensure a pleasant and energy efficient indoor climate.

The classrooms are highly durable and can be assembled in a few days.

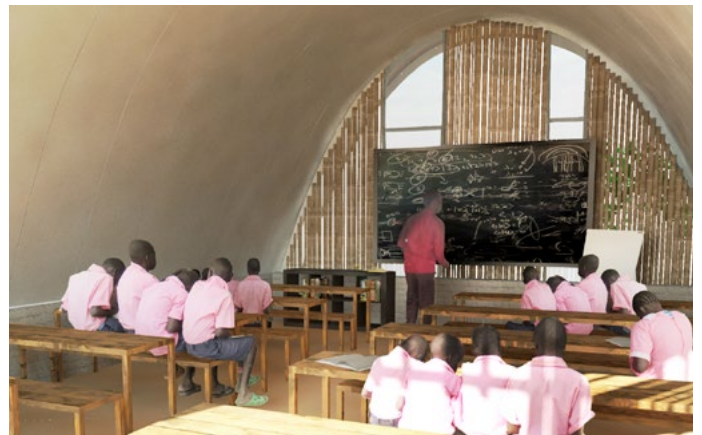

Lifeshelter® Classroom



Specifications*

Expected Life Span	25+ years
Assembly Time	2-3 days / 3 people
Floor Area	~34 m ²
Dimensions (HxWxL)	3.41x4.95x7.80m
Door dimension	H:196cm W: 80cm
Fire Safety	Euro Class: b2sd0
Wind Speed Resistance	120 km/t / 32,6 m/s
Thermal Conductivity	0,039W/m ² *K
Panel weight	27 kg
Container (40 ft.)	12 shelters

*Subject to customer preferences



Earthquake resistant



Fire resistant



Hurricane resistant

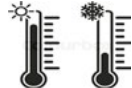

Resistant to both high and low temperatures



Noise reducing



Waterproof



Produced locally

Construction

Good quality construction materials secure the structure to withstand exposure against the forces of nature, tear and wear. The quality of the foundation base is essential to a long life span.

Evershelter recommends hiring a competent and experienced local contractor for the construction of foundations.

In specific situations, a foundation with simplified specification can be used to obtain sufficient strength.

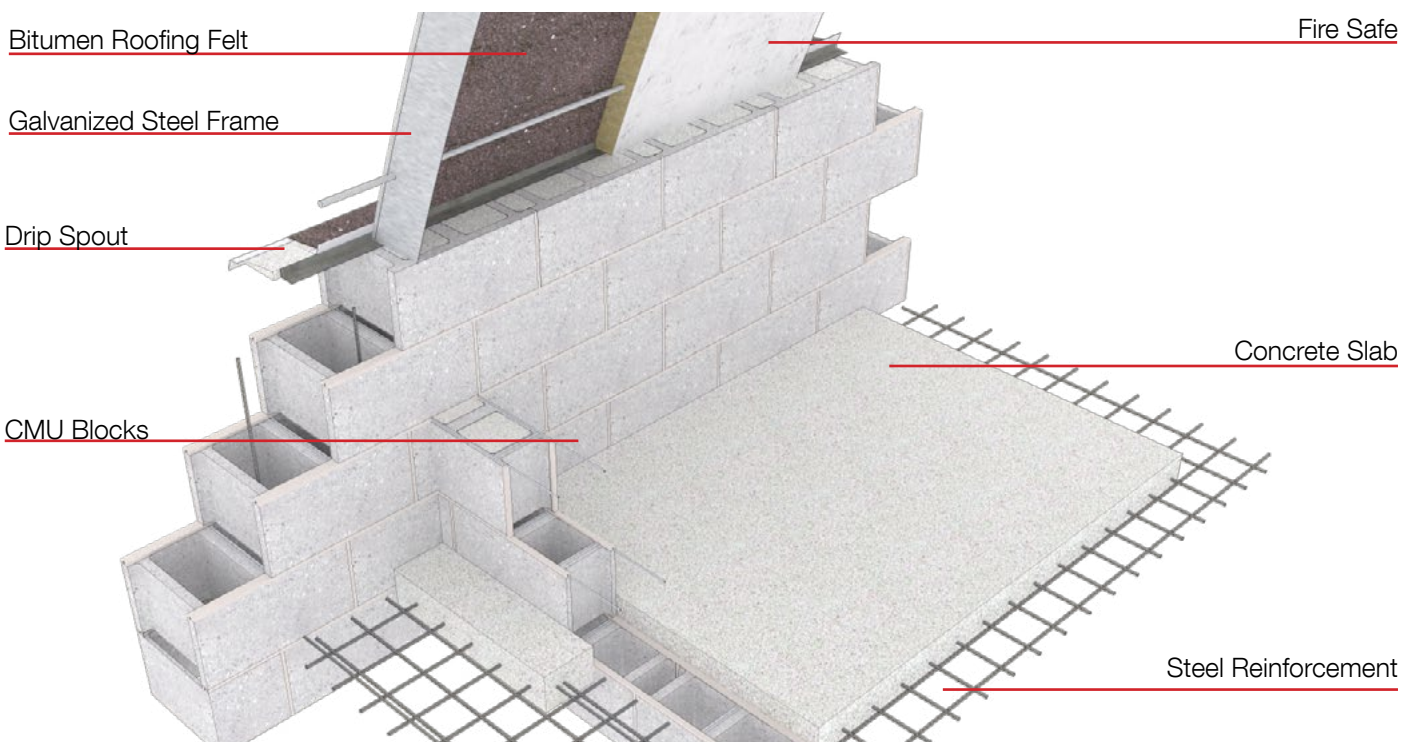



Lifeshelter panels can be produced locally by unskilled labour, and production facilities can be prepared in any large warehouse in only a few weeks and can be scaled to demand.

The local production supports local economic growth by providing jobs, upgrading skills and creating new export opportunities.

Local production opportunities

At Evershelter we strive to promote sustainable economic growth, productive employment and decent work in the countries we work in. Refugee host countries often face severe economic challenges, and we recognize that the abovementioned factors are crucial to create conditions which allow people to become less aid dependent and resilient, and eventually lift them out of poverty.

Instead of making an explicit donation our business model is designed as an income generating project that ensure a more viable and sustainable social impact.



Local economy

Evershelter aims to maximize our economic contribution to the community, procuring all available materials from local suppliers, mostly using local contractors, sales agents and labor and co-owning the factories with local business partners



Local jobs

A typical production cell with a monthly capacity of 600 shelters will create 50 full time jobs, and 150 indirect jobs for logistic services, building construction, assembly and administration



Export opportunities

A factory will give the host country and local partners the potential to become strong exporters of housing solutions to neighbouring countries, increasing the potential market size and contributing to the trade balance and economy.



Capacity building

A local production cell will provide on-the-job-training to workers in the factory in various production methods and ensure knowledge and technology transfer for suppliers and contractors involved in logistics, construction, assembly and maintenance of the solutions from the factory.



High capacity

Production capacity can quickly be scaled by demand and new production cells can be established in any large warehouse in a few weeks. The proximity to market and short production time secures lead times of less than 26 weeks for 4.000 shelters.



The shelters typically used in Kigoma, Tanzania are made up of wood rafters, trusses and plastic sheeting. Replacing these with Lifeshelters eliminates the need for wood, and thereby prevent deforestation and impoverishing the scarce local resources. Resources which are vital as a food source for grassing domestic animals, and to avoid wildfire and flooding's. Over 45,000 trees can be saved annually for every 1.000 typical shelters of trees and plastic replaced by Lifeshelter®.

Our world - Our responsibility

At Evershelter we are committed to developing and producing sustainable solutions for the inhabitants of our shelters, the local society as well as for the environment.

In our effort to advance the Sustainable Development Goals we support the Ten principles of the UN Global Compact with respect to human rights, labour, environment and anti-corruption. Throughout our value chain we strive to combine bottom line profits, sustainable environmental practices and positive societal impact.



Reusable

Lifeshelter panels can any time be reused as insulating boards in new or existing buildings. Thereby the second life of the product serves the purpose of making permanent building more energy efficient.



Avoiding transitional waste

The increased lifespan of the shelter, and the use of reusable materials will significantly decrease the amount of transitional waste in refugee camps.



Durable

Lifeshelters® are highly resistant to extreme weather conditions and are easily adaptable to all climates. The lifespan can be further increased by upgrading the shelters to more permanent Lifeshelter® solutions.



Energy efficient

Lifeshelters® are made of a high-quality insulating material, which improves energy efficiency significantly and thereby leads to a decrease in CO2 emissions.



Environmentally friendly

The exploitation of natural resources such as deforestation is an occurring problem in developing countries. Production of Lifeshelters® does not contribute to the drainage of scarce natural resources such as native forests.



For more information please visit www.lifeshelter.com

For enquiries and project proposals please contact **EVERSHELTER APS**

E-mail: info@evershelter.com, Tel. +45 31 32 33 63